

CUP-18-09 (Pie Society)

Hold a public hearing and consider a request from Pie Society, on behalf of Hjorting Family Trust, for a renewal of a Conditional Use Permit to allow the sale of mixed beverages for on premise consumption at the Pie Society, located at 700 N LBJ Drive, Suite 107. (T. Carpenter)

Location:

- The restaurant is located at 700 N LBJ Drive
- The nearest intersection is Sessom Drive and N LBJ Drive



CUP-18-09

Pie Society

700 N LBJ Dr, Suite 107

Map Date: 4/26/2018

 Subject Property



0 100 200 400 Feet

This product is for informational purposes and may not have been prepared for or be suitable for legal, engineering, or surveying purposes. It does not represent an on-the-ground survey and represents only the approximate relative location of property boundaries.

Context & History:

- The building is approximately 3000 square feet in size.
- The hours of operation are from 11:30am – 10pm, Monday – Sunday.
- The restaurant has 75 indoor seats and 30 off-street parking spaces.
- The applicant has indicated that there are no other proposed changes to the business or site.



CUP-18-09
Ple Society
700 N LBJ Dr, Suite 107
Map Date: 4/26/2018

 Subject Property
 Notification Buffer



0 100 200 400 Feet

This product is for informational purposes and may not have been prepared for or be suitable for legal, engineering, or surveying purposes. It does not represent an on-the-ground survey and represents only the approximate relative location of property boundaries.

Floor Plan

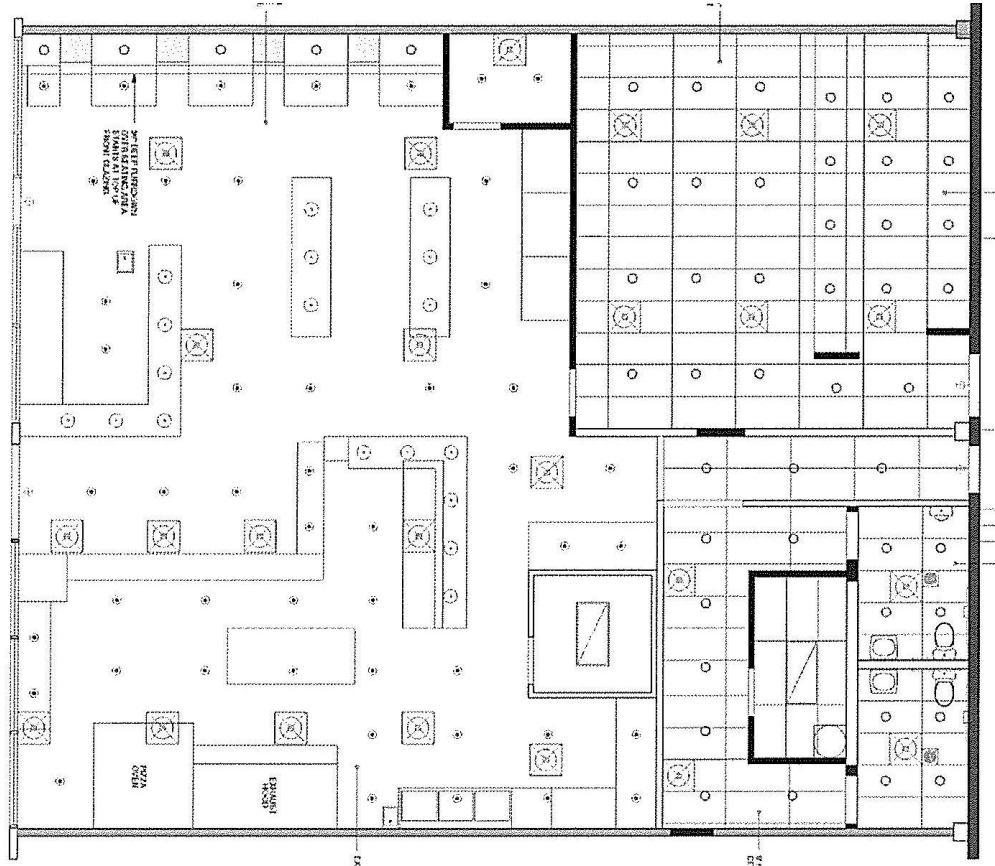

Recommendations:

Staff provides this request to the Commission for your consideration and recommends **approval** of the Conditional Use Permit with the following conditions:

- 1. The CUP shall be valid for the life of the TABC license, provided standards are met, subject to the point system; and**
- 2. The CUP shall be posted in the same area and manner as the Certificate of Occupancy.**