

1. SLOPE ALONG ACCESSIBLE ROUTE NOT TO EXCEED 1:20 UNLESS DESIGNED AS A RAMP. CROSS SLOPE NOT TO EXCEED 1:50.
2. THRESHOLDS AT DOORWAYS NOT TO EXCEED 1/2" RISE. SLOPE FOR FLOOR LEVEL CHANGES AT DOORWAYS SHOULD BE BEVELED WITH A SLOPE NO GREATER THAN 1:2.
3. PARKING SPACES AND ACCESS AISLES SHALL BE LEVEL WITH SURFACE SLOPES NOT EXCEEDING 1:50 IN ALL DIRECTIONS.
4. IN THE PARKING AREA AND SIDEWALK IMMEDIATELY IN FRONT OF THE BUILDING, AT A MINIMUM, THE CURBS, ADA RAMPS, ADA PARKING SPACES AND CROSS WALKS SHALL BE RE-STRIPPED AND/OR PAINTED TO CLEARLY INDICATE THE ACCESSIBLE ROUTE. CONTRACTOR SHALL COORDINATE WITH THE ARCHITECT AND OWNER ON OTHER AREAS OF RE-PAVING, RE-SEALING, RE-STRIPING AND/OR PATCHING THE EXISTING ASPHALT PARKING LOT.
5. SEE SHEETS G102 AND G103 FOR DETAILS REGARDING ACCESSIBILITY STANDARDS.
6. REFER TO CIVIL DRAWINGS SITE DEMO INFORMATION.



SAN MARCOS, TX

CONSULTANT

SIGNED: 11/25/2015

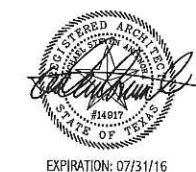
[illegible]

ISSUE:	PERMIT SET
DATE:	11/25/2015
PROJECT NO:	2015-01-01
DRAWN BY:	WAC
CHECKED BY:	JCG

A000

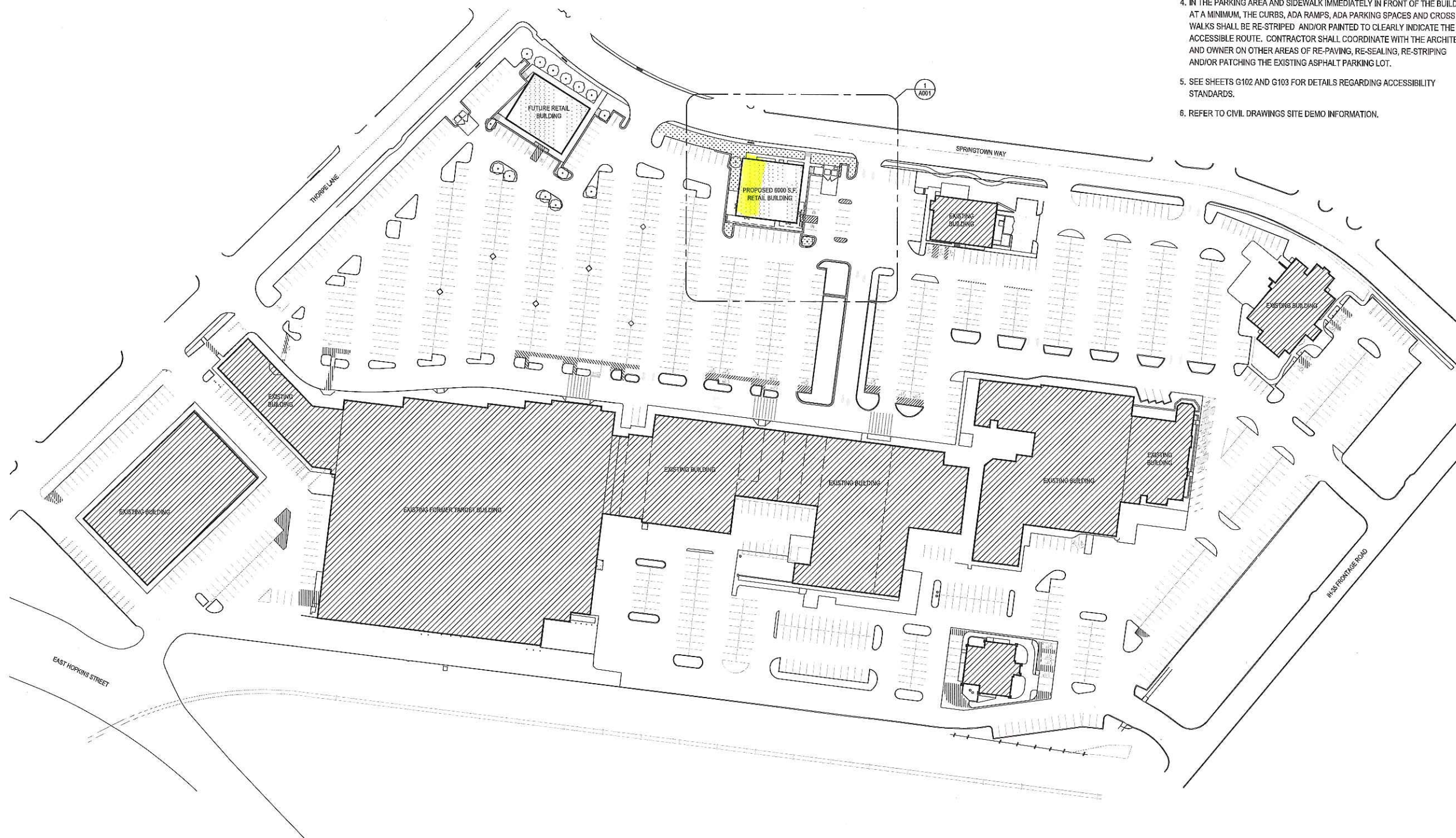

1 SITE PLAN (FOR REFERENCE ONLY)
scale 1/64"=1'-0"

