

Ramon Lucio Park | Public Art Proposal

MOIRÉ SKY

Shane Allbritton + Peter Bernick-Allbritton



INSPIRATION

Inspired by the natural river systems that shape the culture and beauty of San Marcos, *Morié Sky* becomes a beacon, distilling a vertical elevation of a gradient of colors opening toward the sky. From earth near the bottom moving upward to the river and further upward into azure sky blue. The top of the sculpture is rendered in polished stainless steel as to reflect the atmospheric qualities of the changing sky and the immediate environment. As the viewer moves around the form, the overlapping lines will create an interference pattern, called a morié, that appears to vibrate. This interactive component can give the effect that it is moving or in motion, like a river.

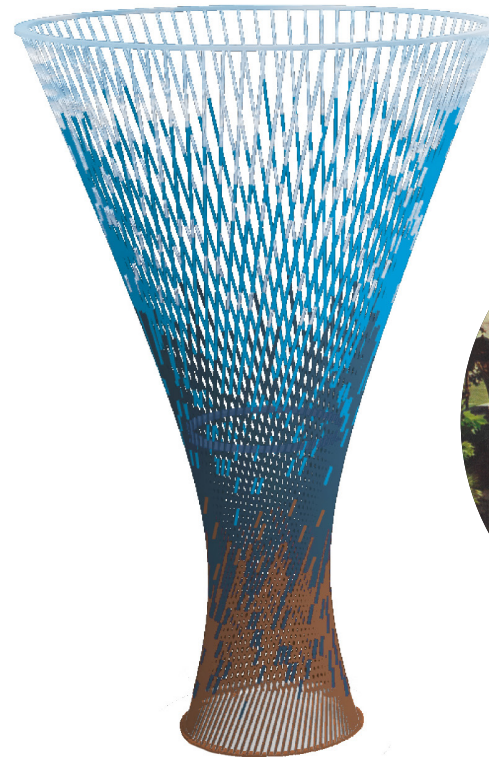
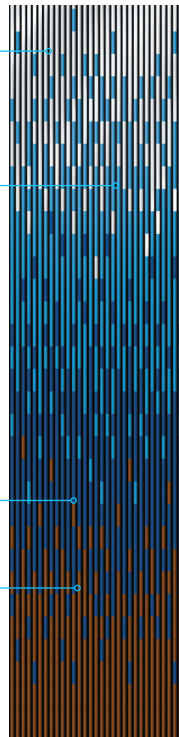
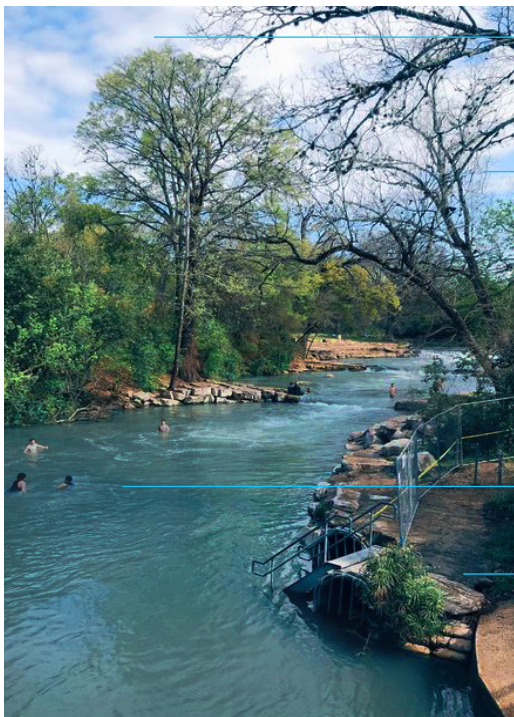

Form inspiration: *Morning Glories* by Buck Winn at Aquarena Springs



UPWARD VIEW



AERIAL VIEW

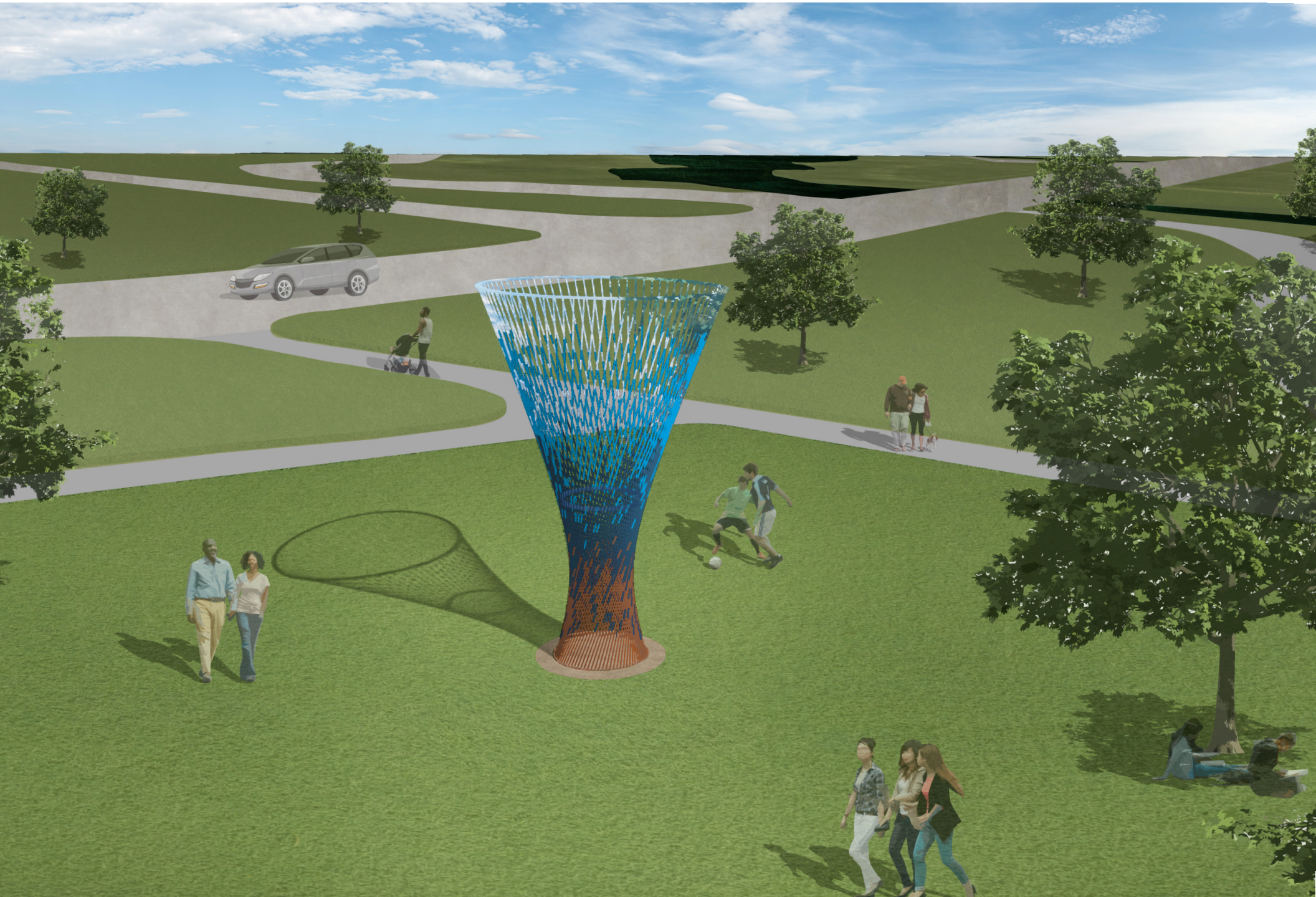

SOLAR LIGHT EXPLORATION

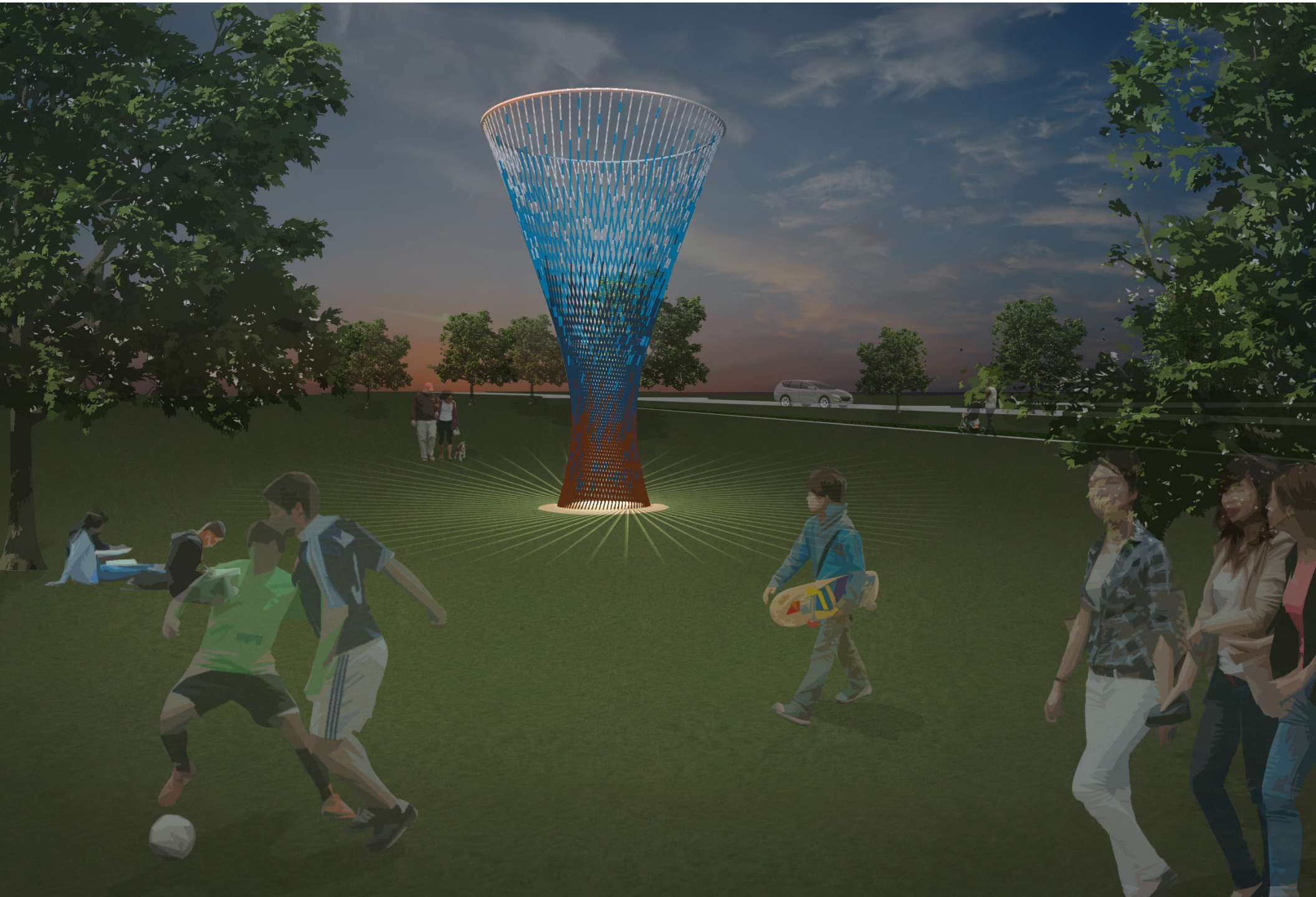

ARTWORK ELEVATION

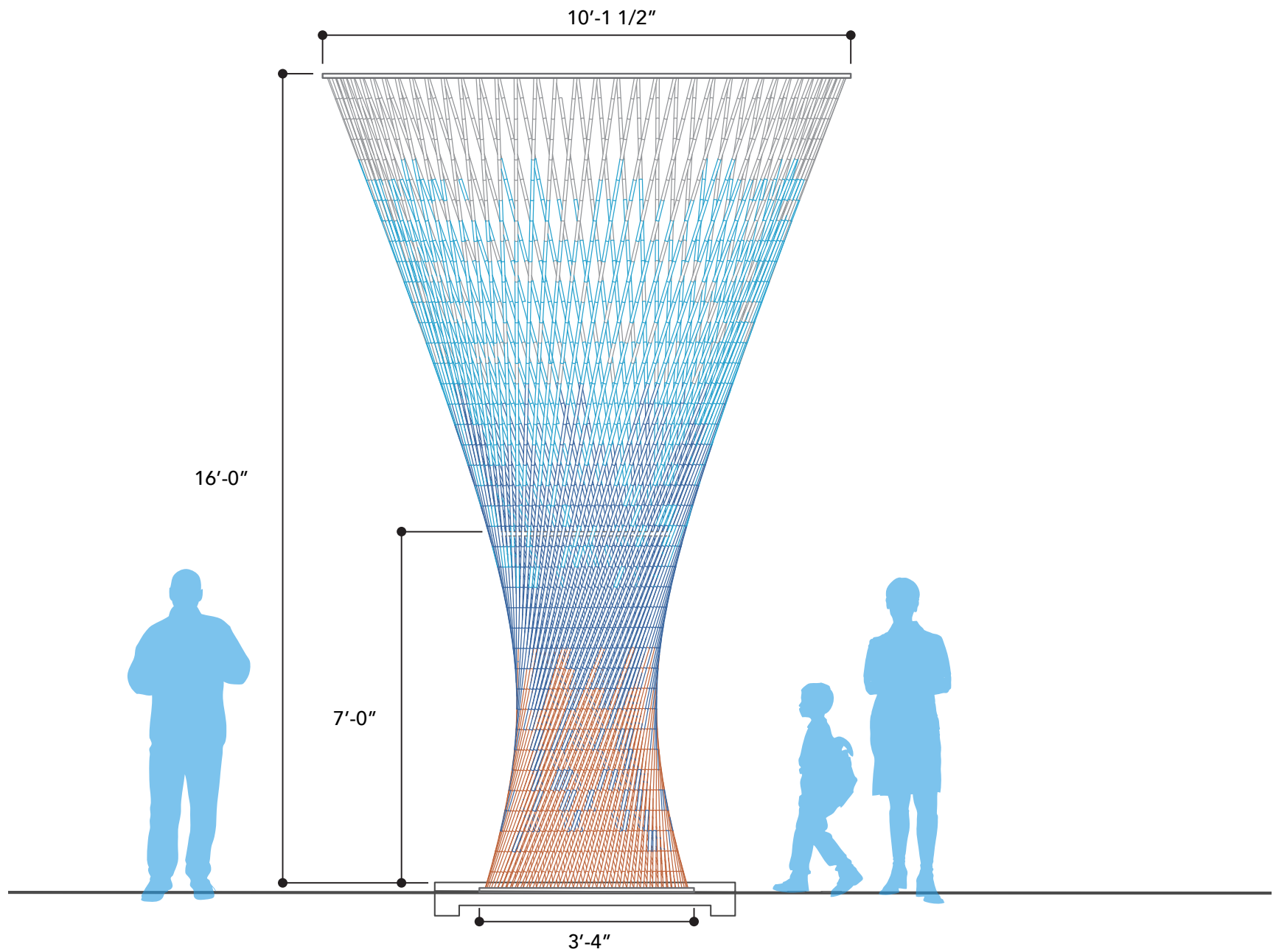

INSTALLATION / FABRICATION

Morié Sky is composed of a series of (80) $\frac{3}{4}$ " diameter steel round rod arrayed radially around a 3'-4" diameter steel base plate and 10' diameter steel top plate. The arrayed rods will be painted and welded to the base plates creating an implied ruled surface and diagrid pattern around the sculpture. The rods will be covered with a series of corten, painted, and polished steel sleeves. A small (approx. 24"x24") access panel will be integrated and concealed into the base of the sleeves to provide access to the interior of the base. The base plate will be anchored to a concrete footing with uplighting located at the center.

MATERIALS / MAINTENANCE

The sculpture will be fabricated out of a series of (80) $\frac{3}{4}$ " diameter painted steel rods, as well as corten, painted and polished steel sleeves. The proposed materials will produce a durable product that will require very limited to no maintenance beyond a yearly dusting to keep dust and buildup from gathering. Surfaces should be cleaned with either a soft cloth or a brush, using a solution of mild soap and warm water to reduce any buildup. Surfaces can be damaged if harsh solvents are used for cleaning.

