



EST. 2004 in NYC

# SHAKE SHACK®



Stand For Something Good®



## Burgers

100% all-natural Angus beef. No hormones and no antibiotics ever. Our proprietary Shack blend is freshly ground and served on a non-GMO potato bun.

	<b>ShackBurger®*</b>	Cal
	Cheeseburger with lettuce, tomato, ShackSauce	
\$5.29	Single	550
\$8.09	Double	855
	<b>SmokeShack®*</b>	
	Cheeseburger with all-natural smoked Niman Ranch bacon, chopped cherry pepper, ShackSauce	
\$6.84	Single	620
\$9.64	Double	925
	<b>'Shroom Burger</b>	490
	Crisp-fried portobello mushroom filled with melted muenster and cheddar cheeses, topped with lettuce, tomato, ShackSauce	
\$6.99		
	<b>Shack Stack®*</b>	795
	Cheeseburger and a 'Shroom Burger with lettuce, tomato, ShackSauce	
\$9.59		
	<b>Hamburger*</b>	
	Let us know if you would like lettuce, tomato, pickle or onion	
\$4.29	Single	385
\$6.59	Double	620
	<b>Add bacon +\$1.55</b>	70



## Chicken

100% all-natural cage-free chicken. No hormones and no antibiotics ever. Served on a non-GMO potato bun.

	<b>Chick'n Shack</b>	595
\$6.29	Crispy chicken breast with lettuce, pickles, buttermilk herb mayo	



## Flat-Top Dogs

100% all-natural Vienna beef. No hormones and no antibiotics ever. Served on a non-GMO potato bun.

	<b>Shack-cago Dog®</b>	Cal
	Dragged through the garden with Rick's Picks Shack relish, onion, cucumber, pickle, tomato, sport pepper, celery salt, mustard	
\$4.25		380
	<b>Hot Dog</b>	350
\$3.30	<b>Add Shack cheese sauce +\$0.50</b>	
		70
\$4.59	<b>Chicken Dog</b>	320
	Shake Shack chicken, apple and sage sausage	



## Crinkle Cut Fries

Yukon potatoes. No artificial ingredients.

\$2.99	<b>Fries</b>	420
\$3.99	<b>Cheese Fries</b>	560



## Frozen Custard

Dense, rich, creamy ice cream, spun fresh all day. Our custard base is made from all-natural sugar, never from corn syrup.

	<b>Shakes</b>	Cal
	Hand-spun vanilla, chocolate, salted caramel, black & white, strawberry, peanut butter, coffee Fair Shake	
\$5.29		640-930

	<b>Make it malted +\$0.50</b>	60
	<b>Add whipped cream +\$0.50</b>	75

\$5.59	<b>Shake of the Week</b>	
	Featured custard flavor	
\$5.29	<b>Floats</b>	510
	Root beer, purple cow, creamsicle	



## Cups & Cones

Vanilla, chocolate, flavor of the week

\$3.59	<b>Single Dip</b>	220-280
\$4.59	<b>Double Dip</b>	450-540
\$5.99	<b>Pints To Go</b>	770-910



## Concretes

Frozen custard blended with mix-ins

\$4.59	<b>Single</b>	390-545
\$6.79	<b>Double</b>	780-1090

## Shack Attack

Chocolate custard, fudge sauce, chocolate truffle cookie dough and Mast Brothers Shake Shack dark chocolate chunks, topped with chocolate sprinkles

## Pratt St. Pie Oh My

Vanilla custard and slice of Dangerously Delicious blueberry pancake pie

## Salty Balty

Chocolate and vanilla custard, chocolate truffle cookie dough, cheesecake blondie and sea salt  
5% of sales from our Salty Balty concrete support Moveable Feast, providing nutritious meals at no cost to those in need.

## Design Your Own Concrete

\$3.59	<b>Single</b>	280-320
\$4.79	<b>Double</b>	560-640

## Mix-Ins

\$0.60 each	• Chocolate truffle cookie dough	5-320
	• Chocolate toffee	
	• Strawberry purée	
	• Fudge sauce	
	• Salted caramel sauce	
	• Peanut butter sauce	
	• Marshmallow sauce	
	• Dark chocolate chunks	



## Drinks

	<b>Shack-made Lemonade</b>	Cal
	Original or featured flavor	
\$2.80	<b>Small</b>	130-155
\$3.55	<b>Large</b>	195-235

## Organic Fresh Brewed Iced Tea

\$2.30	<b>Small</b>	0
\$2.80	<b>Large</b>	0

## Fifty/Fifty™

	Half lemonade, half organic iced tea	
\$2.55	<b>Small</b>	80
\$3.30	<b>Large</b>	115

## Fountain Soda

	Coke, Diet Coke, Coke Zero, Sprite, Fanta Orange, Fanta Grape, Dr Pepper	
\$2.30	<b>Small</b>	0-180
\$2.80	<b>Large</b>	0-270

## Abita Draft Root Beer

\$2.80	<b>Small</b>	180
\$3.55	<b>Large</b>	270

## Stumptown Cold Brew Coffee

\$4.75		3
	Brewed with Direct Trade beans	

## Honest Kids Organic Apple Juice

\$1.90		40
--------	--	----

\$2.40	<b>SHACK   :O® Bottled Water</b>	0
	1% supports the cleanup of water sources	



## Beer

	<b>ShackMeister® Ale</b>	Cal
	Brewed exclusively for Shake Shack by Brooklyn Brewery	
\$5.69	<b>Draft, 16oz.</b>	190
\$7.69	<b>Draft, 24oz</b>	285



## Wine

	<b>Shack Red or White</b>	Cal
	Made exclusively for Shake Shack by Frog's Leap, Napa Valley, CA	
\$7.89	<b>White, 6oz. Glass</b>	120
\$8.89	<b>Red, 6oz. Glass</b>	125



## Woof

Treats for those with four feet.

\$3.99	<b>Pooch-ini®</b>	
	ShackBurger dog biscuit, peanut butter sauce, vanilla custard Not intended for small dogs.	
\$7.99	<b>Bag O' Bones</b>	
	5 ShackBurger dog biscuits by Bocce's Bakery	

2,000 calories a day is used for general nutrition advice, but calorie needs vary.

Please inform your cashier if a person in your party has a food allergy. Peanuts, nuts and other food allergens are present at Shake Shack. We cannot guarantee that our products will be free of the eight major allergens identified by the FDA.

\*Notice: consuming raw or undercooked meats, poultry, seafood, or eggs may increase your risk of foodborne illness, especially if you have certain medical conditions.

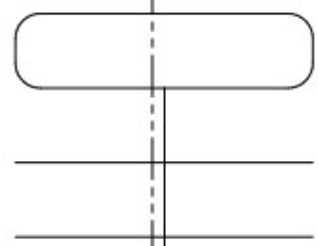
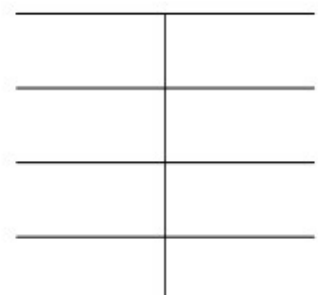
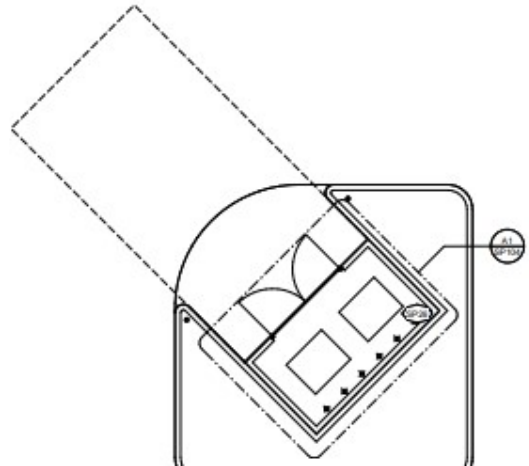
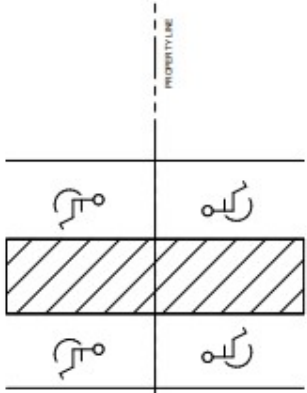
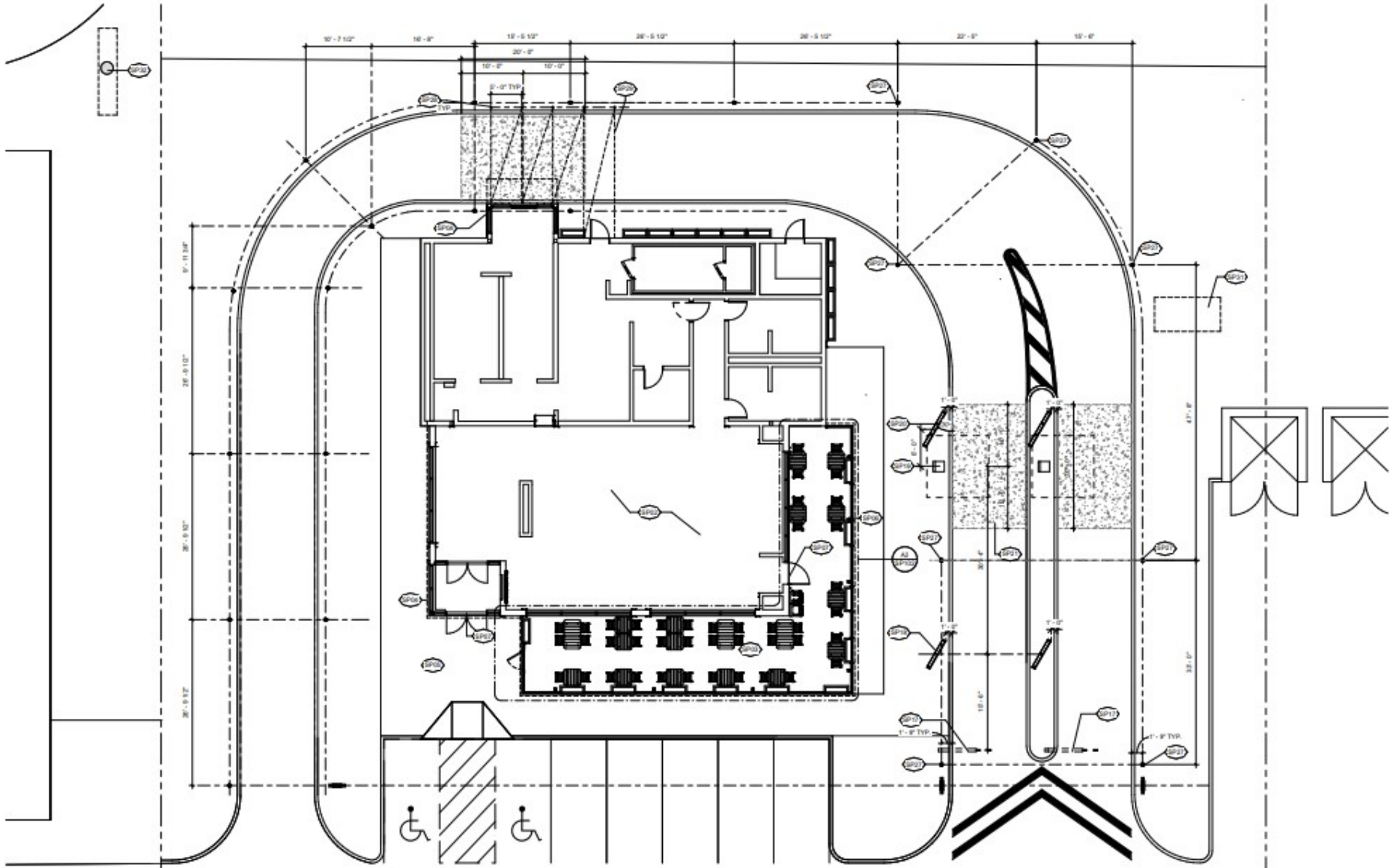

EX CONCRETE PAVEMENT

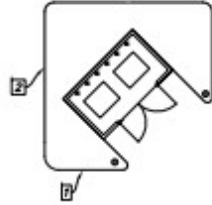

EX CONCRETE PAVEMENT

EX CONCRETE PAVEMENT

EXISTING BUILDING  
(OUTBACK STEAKHOUSE)

OUTDOOR PATIO

**SHAKE SHACK**  
3,546 SF

EXISTING BUILDING  
(PURPLE)

EXISTING BUILDING  
(KIRKLANDS)

T

W

EX SIGN

**NORTHBOUND FRONTAGE ROAD**

EX ASPHALT PAVEMENT



Join TABC in the fight against human trafficking

L-CERT (7/2022)

Submit this form to the proper officials to obtain certification for the type of license/permit for which you are applying as required by TX Alc. Bev. Code, Sections 11.37, 11.39, 11.46(b), 61.37, 61.38, 61.42 and Rule §33.13. This Required Certifications form must be submitted with your Initial Application form. Contact your local TABC office for assistance.

LOCATION INFORMATION

Form fields including: 1. Trade Name of Location (Shake Shack), 2. Owner of Business/Applicant (Shake Shack Texas Beverage Company, LLC), 3. Type of Owner, 4. Location Address (San Marcos, TX), 5. Mailing Address (New York, NY), 6. Business Telephone Number, 7. Application for, 8A. Type of Off-Premise Retailer License/Permit, 8B. Type of On-Premise Retailer License/Permit, 8C. Type of Wholesaler's, Distributor's, or Manufacturer's License/Permit, 9. For On or OFF-Premise Applicants, Indicate Primary Business Type at this Location.

