

AN-22-08 Aerial View Posey Road Industrial Park Transportation Way/ Posey Rd

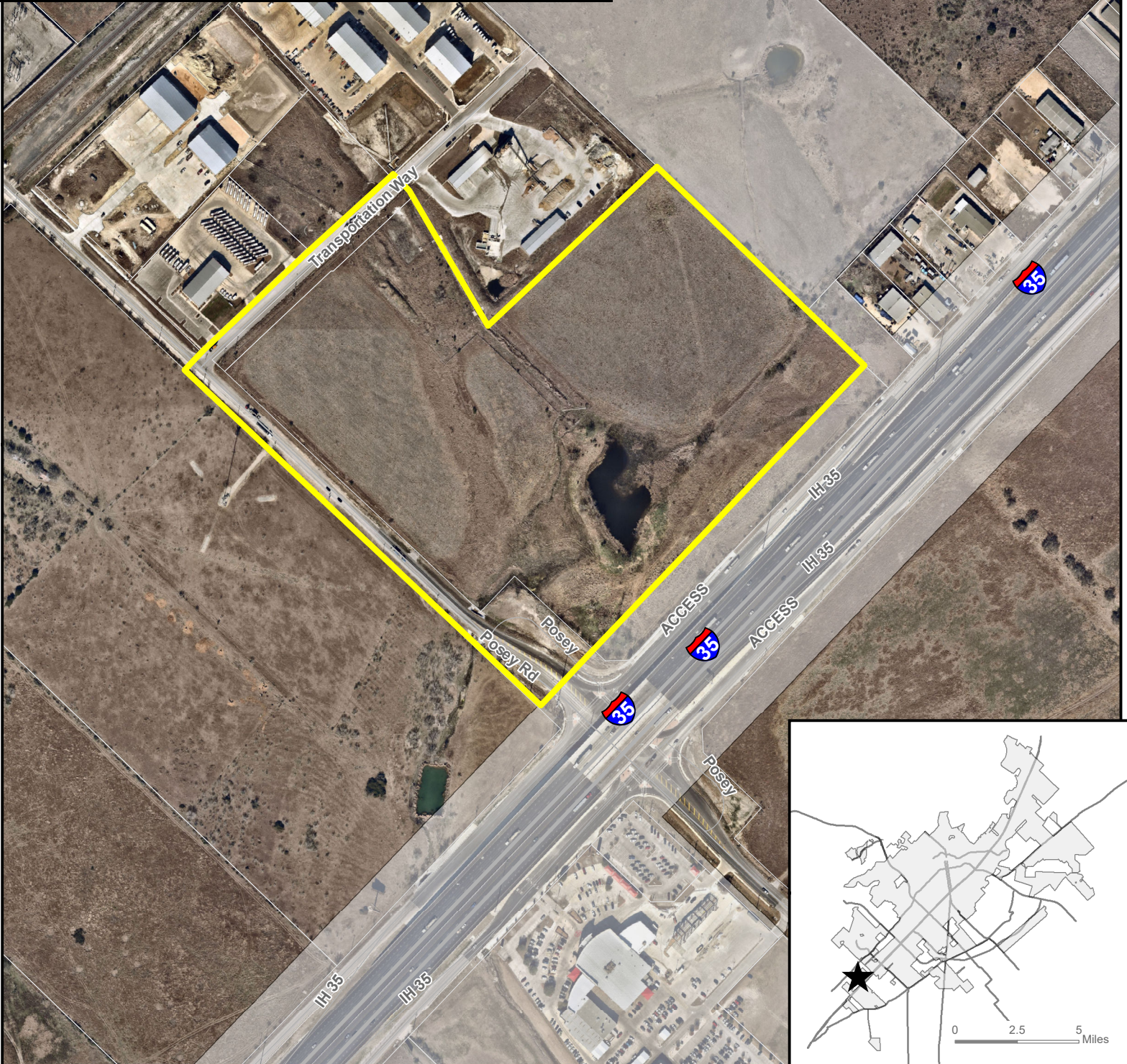

Site Location



Subject Property



Parcel



City Limit









0 250 500 1,000 Feet

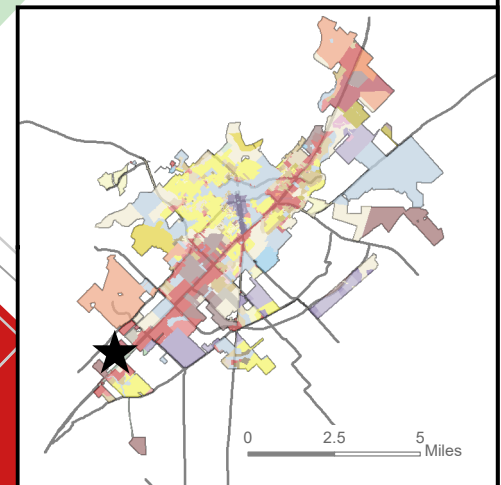



This product is for informational purposes and may not have been prepared for or be suitable for legal, engineering, or surveying purposes. It does not represent an on-the-ground survey and represents only the approximate relative location of property boundaries. Imagery from 2017.

Map Date: 3/10/2022

AN-22-08 Existing Zoning Posey Road Industrial Park Posey Rd/Transportation Way



	Planning Area (PA)		General Commercial (GC)
	Agriculture Ranch District (AR)		Heavy Commercial (HC)
	Future Development (FD)		Light Industrial (LI)

-  **Site Location**
-  **Subject Property**
-  **Parcels**
-  **City Limit**

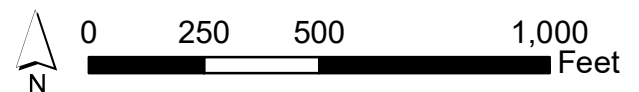

This product is for informational purposes and may not have been prepared for or be suitable for legal, engineering, or surveying purposes. It does not represent an on-the-ground survey and represents only the approximate relative location of property boundaries.

Map Date: 3/11/2022

AN-22-08 Transportation Master Plan Posey Rd Industrial Park—Transportation Way/Posey Rd

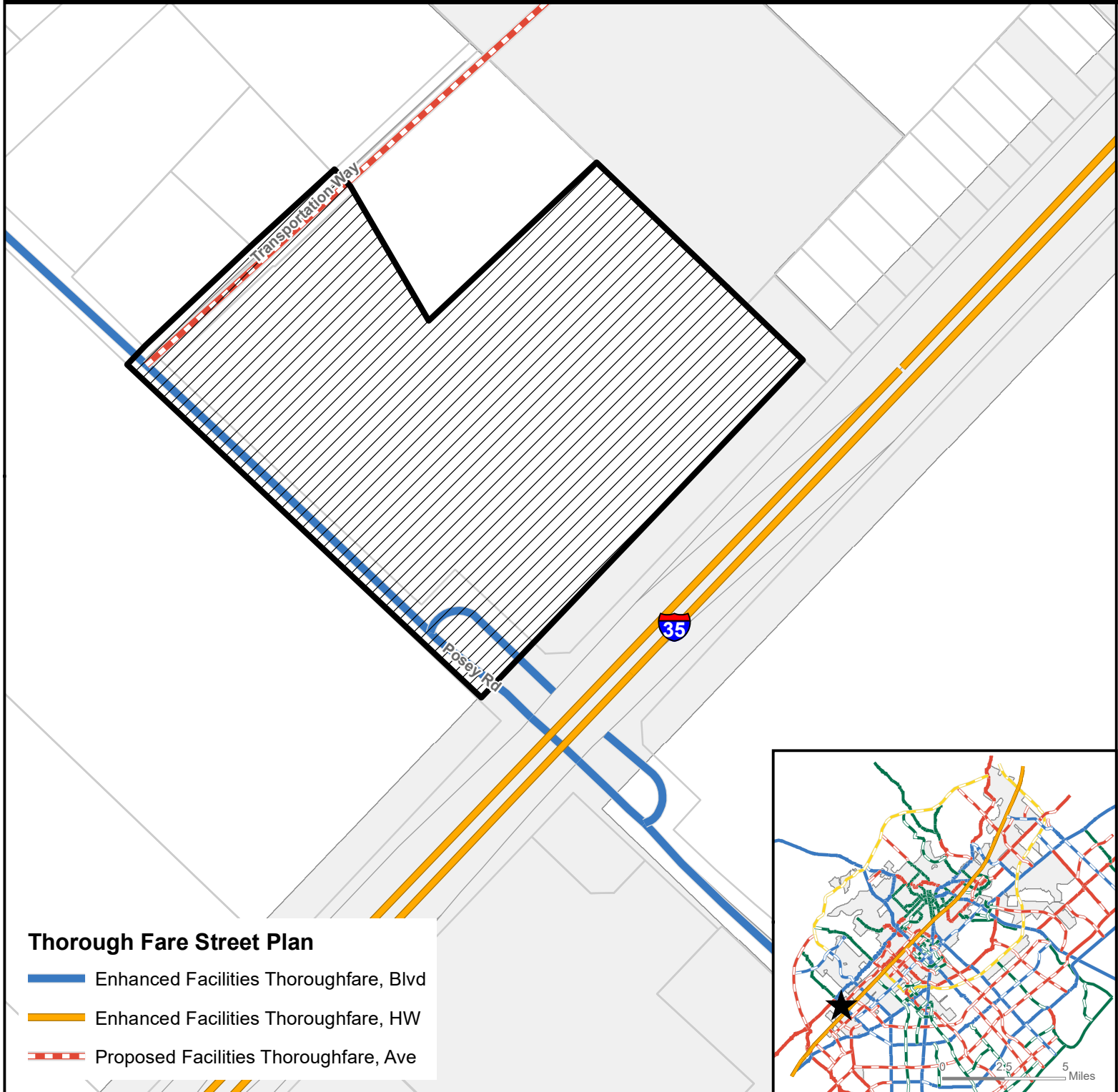

- ★ Site Location
- ▨ Subject Property
- Parcels
- City Limit

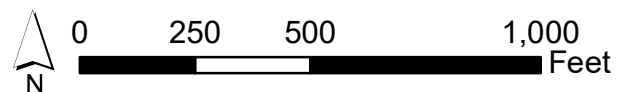

This product is for informational purposes and may not have been prepared for or be suitable for legal, engineering, or surveying purposes. It does not represent an on-the-ground survey and represents only the approximate relative location of property boundaries.

Map Date: 4/14/2022

AN-22-08 Water/Wastewater Lines Posey Road Industrial Park—Transportation Way/Posey Rd

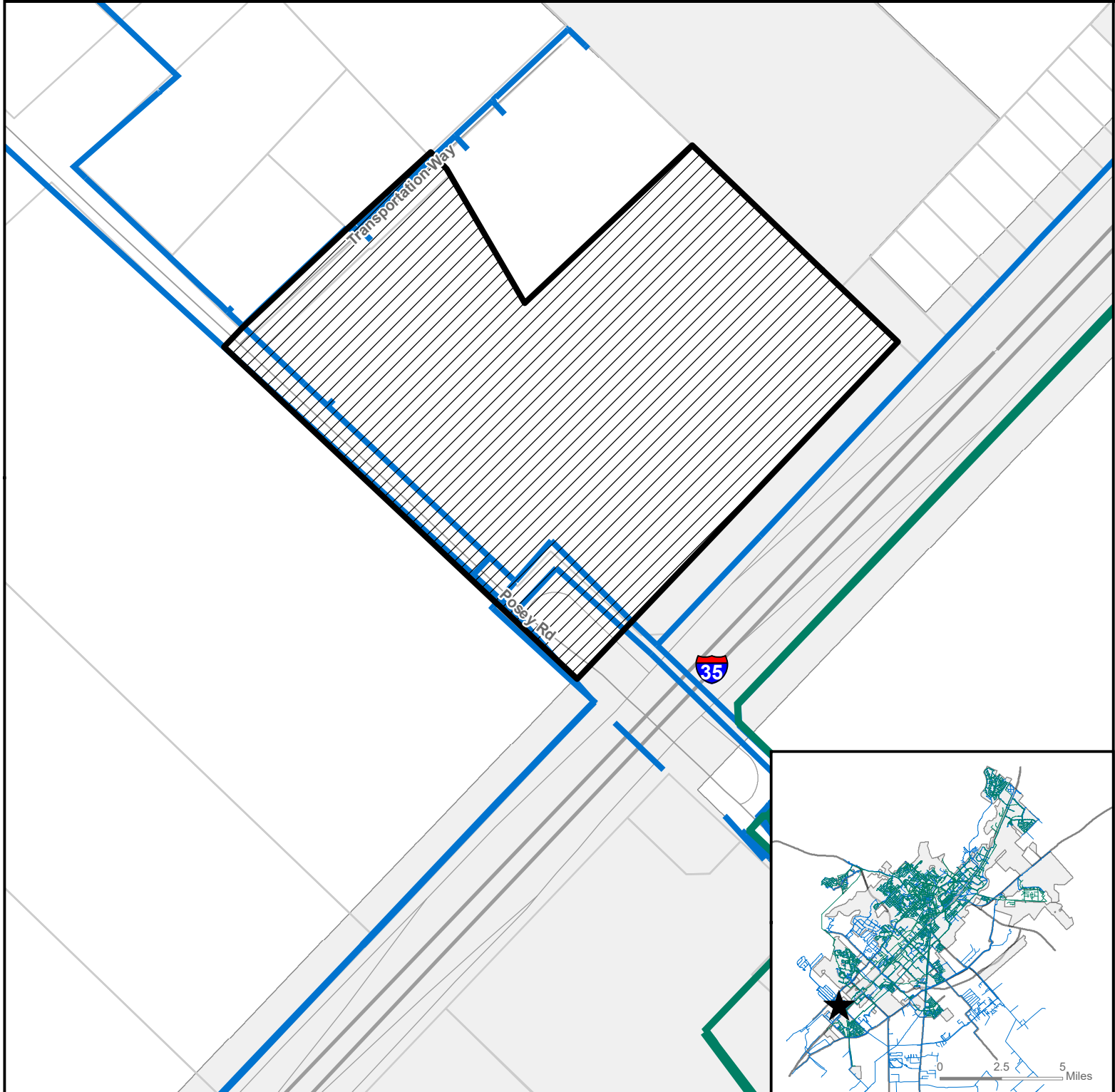

- ★ Site Location
- ▨ Subject Property
- Parcels
- City Limit
- Sanitary Main
- Water Main

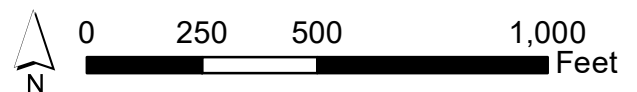

This product is for informational purposes and may not have been prepared for or be suitable for legal, engineering, or surveying purposes. It does not represent an on-the-ground survey and represents only the approximate relative location of property boundaries.

Map Date: 4/14/2022

AN-22-08 Environmental Features Posey Rd Industrial Park-Transportation Way/Posey Rd

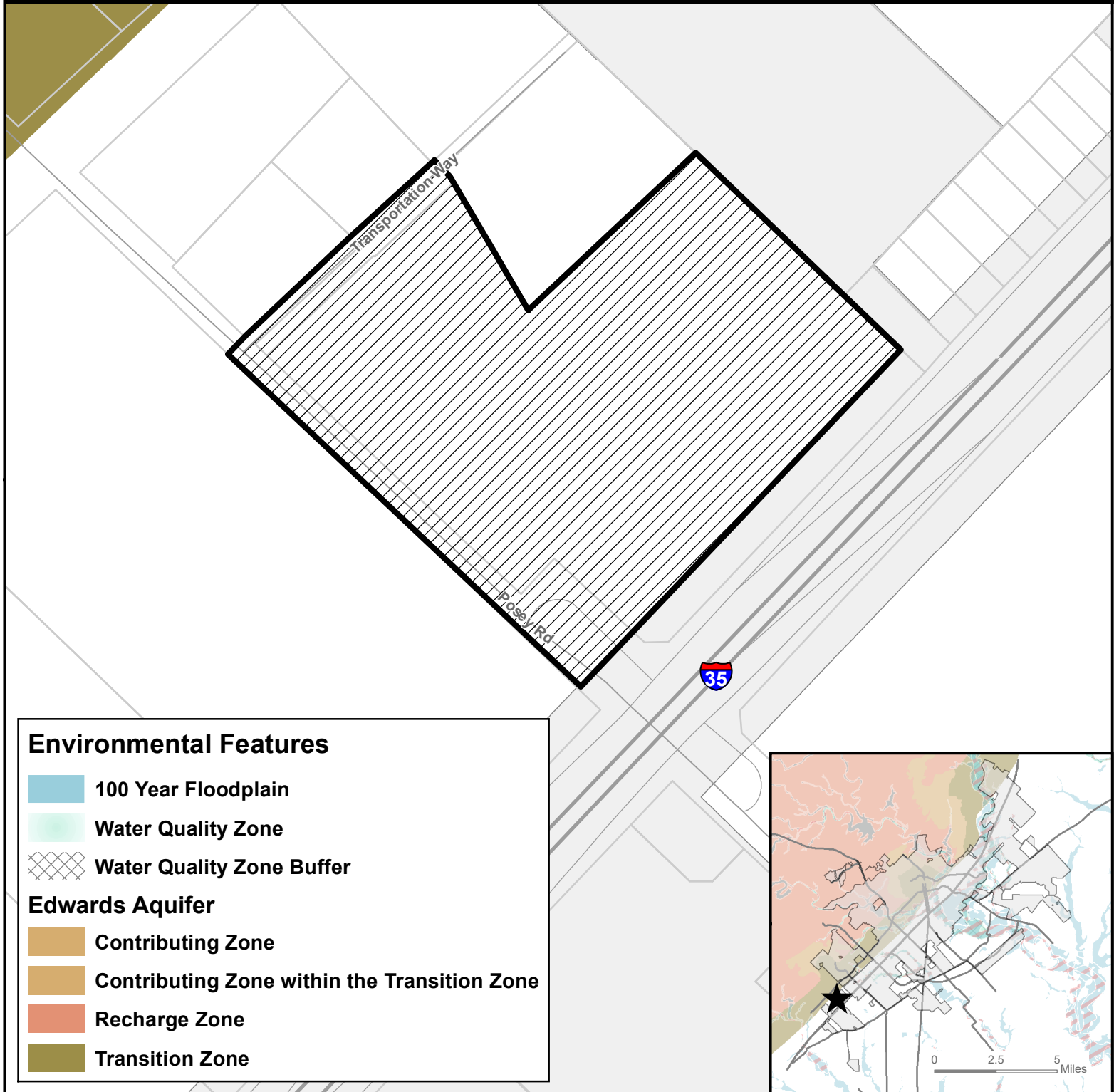

- ★ Site Location
- ▨ Subject Property
- Parcels
- City Limit

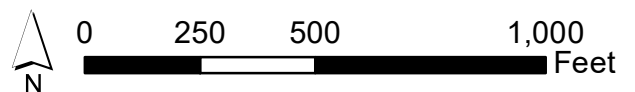

This product is for informational purposes and may not have been prepared for or be suitable for legal, engineering, or surveying purposes. It does not represent an on-the-ground survey and represents only the approximate relative location of property boundaries.

Map Date: 4/14/2022

Figure 112: SMFD 8-Minute Effective Response Force
Six fire stations with Station 2 relocated to Centerpoint, and Station 6 at Old Bastrop west of Posey with minimum staffing of 20 personnel.

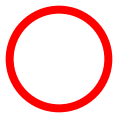
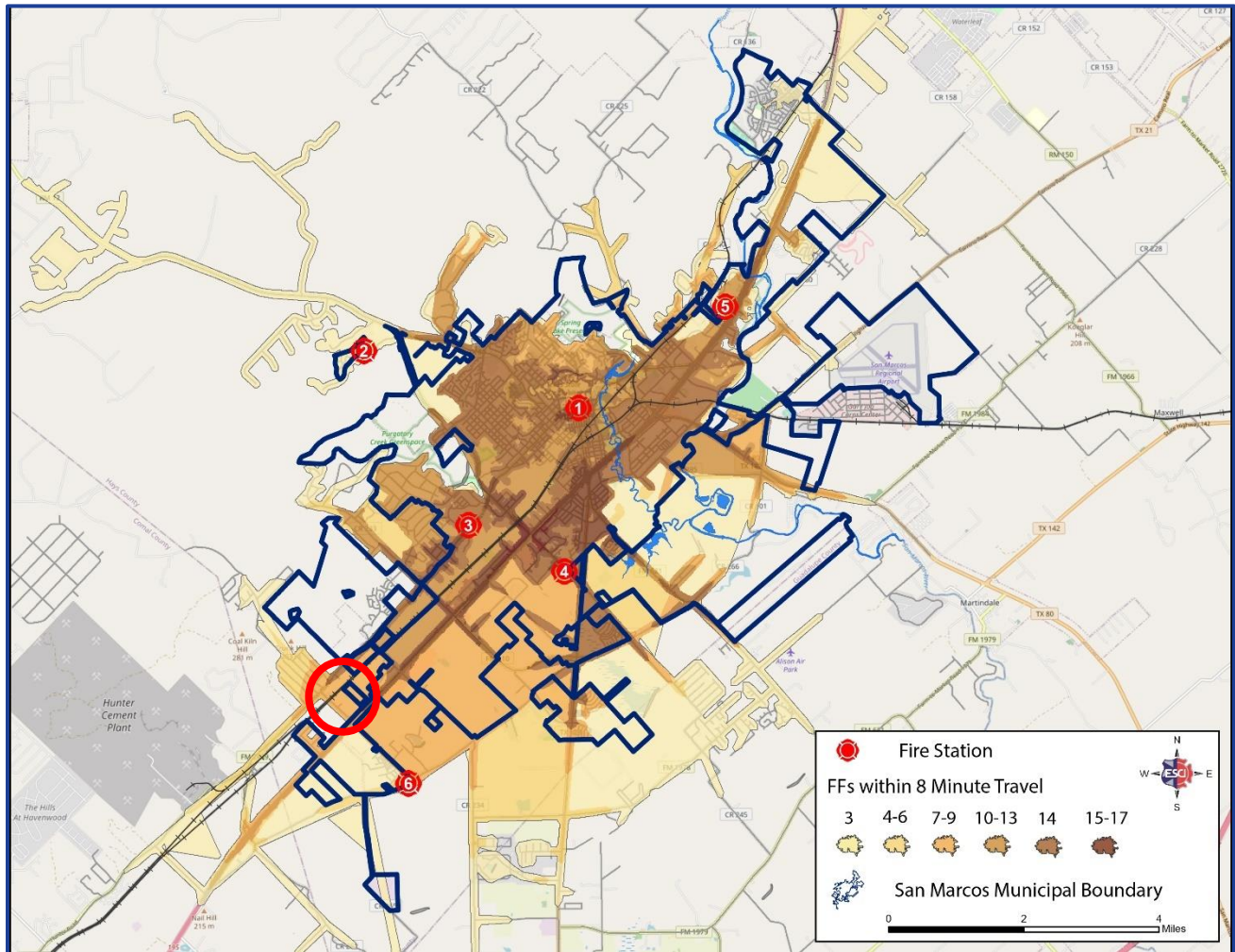

AN-22-08/ZC-22-15/ZC-22-16 Approximate Location