



Presentation

Item

913 Horace Howard Drive/ Resolution 2025-#

Consider approval, by motion, authorizing an Out-Of-City Utility Connection request for water service by Radius Civil Engineering, on behalf of Zachary McDonald, for an approximately 25.5 acres Manufactured Home Community lot located at 913 Horace Howard Drive.

Property Information

Approximately 25.5 acres

Located on Horace Howard Drive,
west of South Old Bastrop Highway.

NOT located within City Limits
NOT located within ETJ

Proposed

- 26 unit Manufacture Home Community

OCU-25-04

Horace Howard Drive

Aerial Map



Subject Property
Parcel

0 125 250 500 Feet

Site Location

This product is for informational purposes and may not have been prepared for or be suitable for legal, engineering, or surveying purposes. It does not represent an on-the-ground survey and represents only the approximate relative location of property boundaries.

Date: 5/14/2025

SAN MARCOS Planning and Development Services

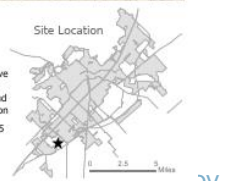

Existing Utilities

Currently occupied by a Single-Family Home and Accessory Structure

Requesting a larger meter to existing water service connection

Connection to existing 2" waterline

CCN Holders

- City's Water CCN
- Pedernales Electric Service Area

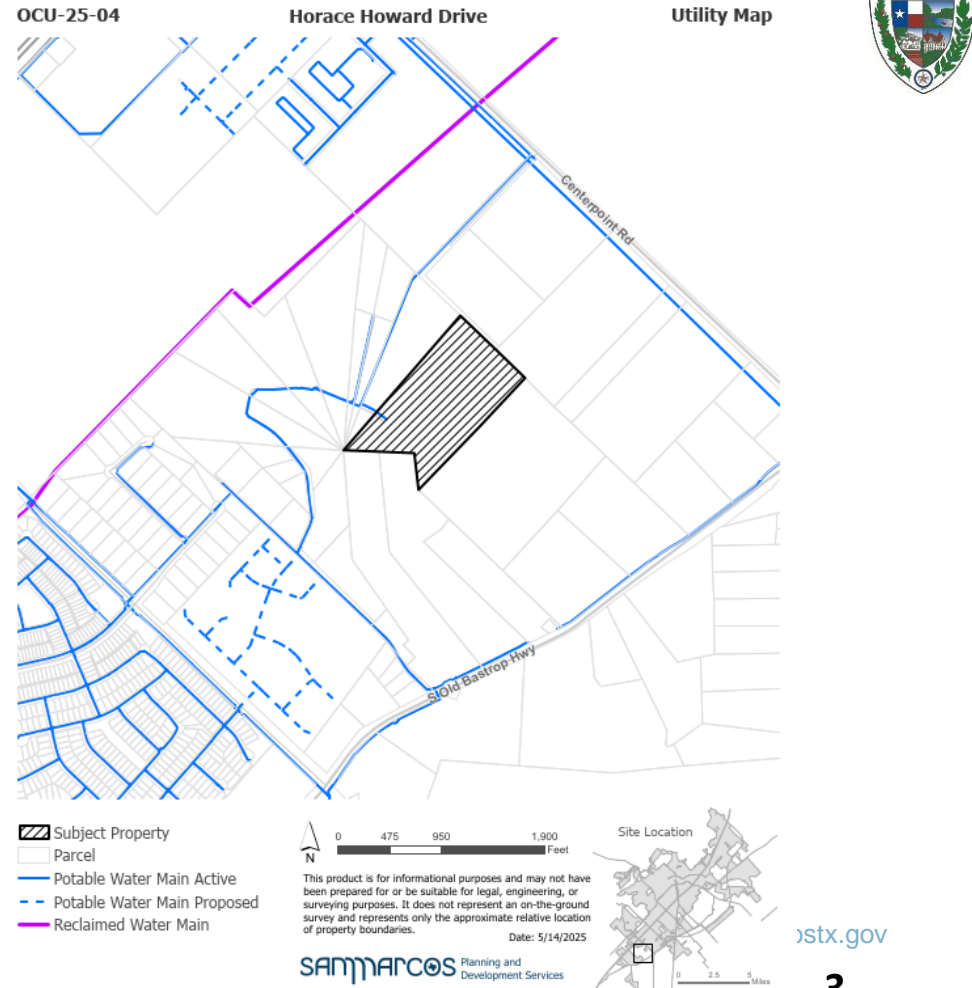



Recommendation



Staff recommends approval of OCU-25-04 as presented.