

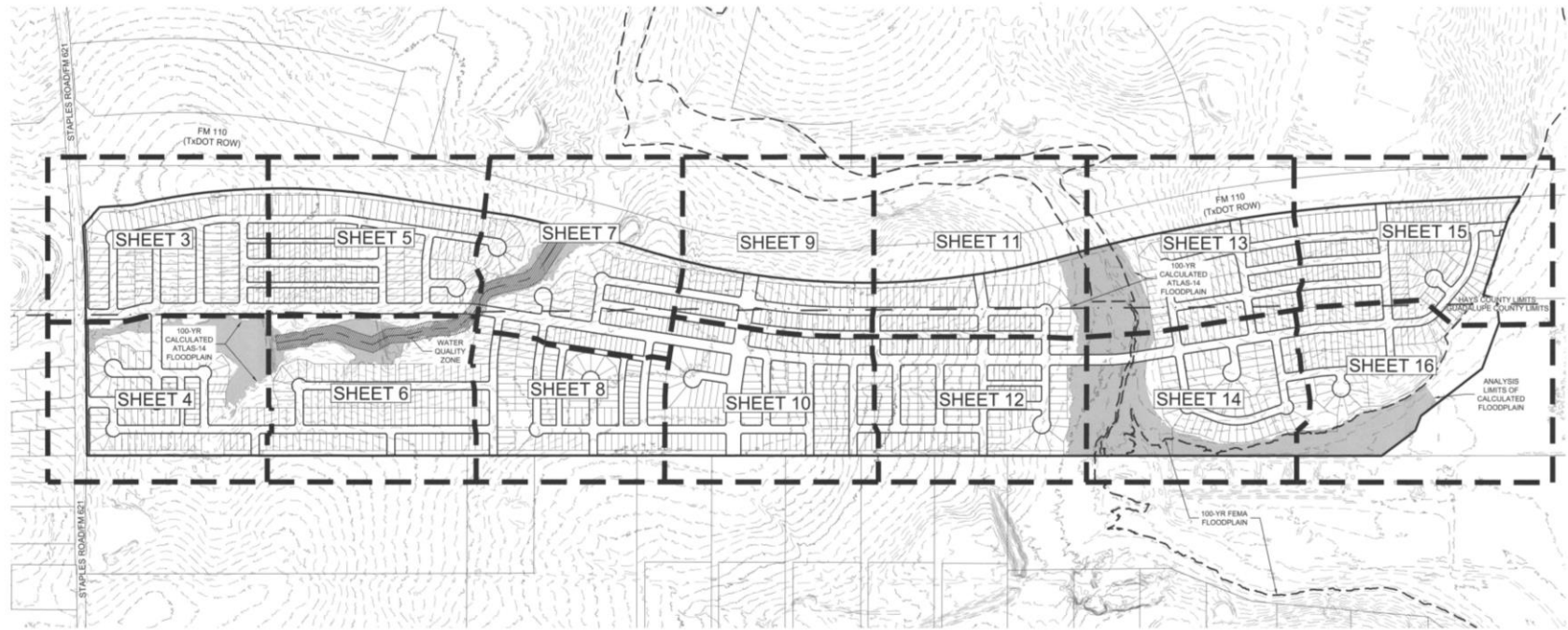

PC-22-47

River Bridge Ranch Preliminary Plat

Consider a request by LJA Engineering, Inc, on behalf of Lennar Homes of Texas, for a Preliminary Plat of approximately 328.85 +/- acres of land out of the Benjamin and Graves Fulcher Survey, Abstract No 813; the William A Matthews Abstract No. 305; the William Burnett Jr. Survey, Abstract No. 56 in Hays County Texas, and the Benjamin and Graves Fulcher Survey, Abstract No. 21 in Guadalupe County, Texas, generally located southeast of the intersection of FM-110 and Staples Rd. (J. Cleary)

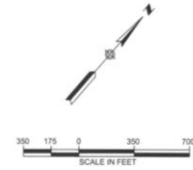



Recommendation

- Staff recommends approval of the plat as presented.