

ZC-20-01 Aerial View FD to SF-4.5 — La Cima Phase 1, Section 2

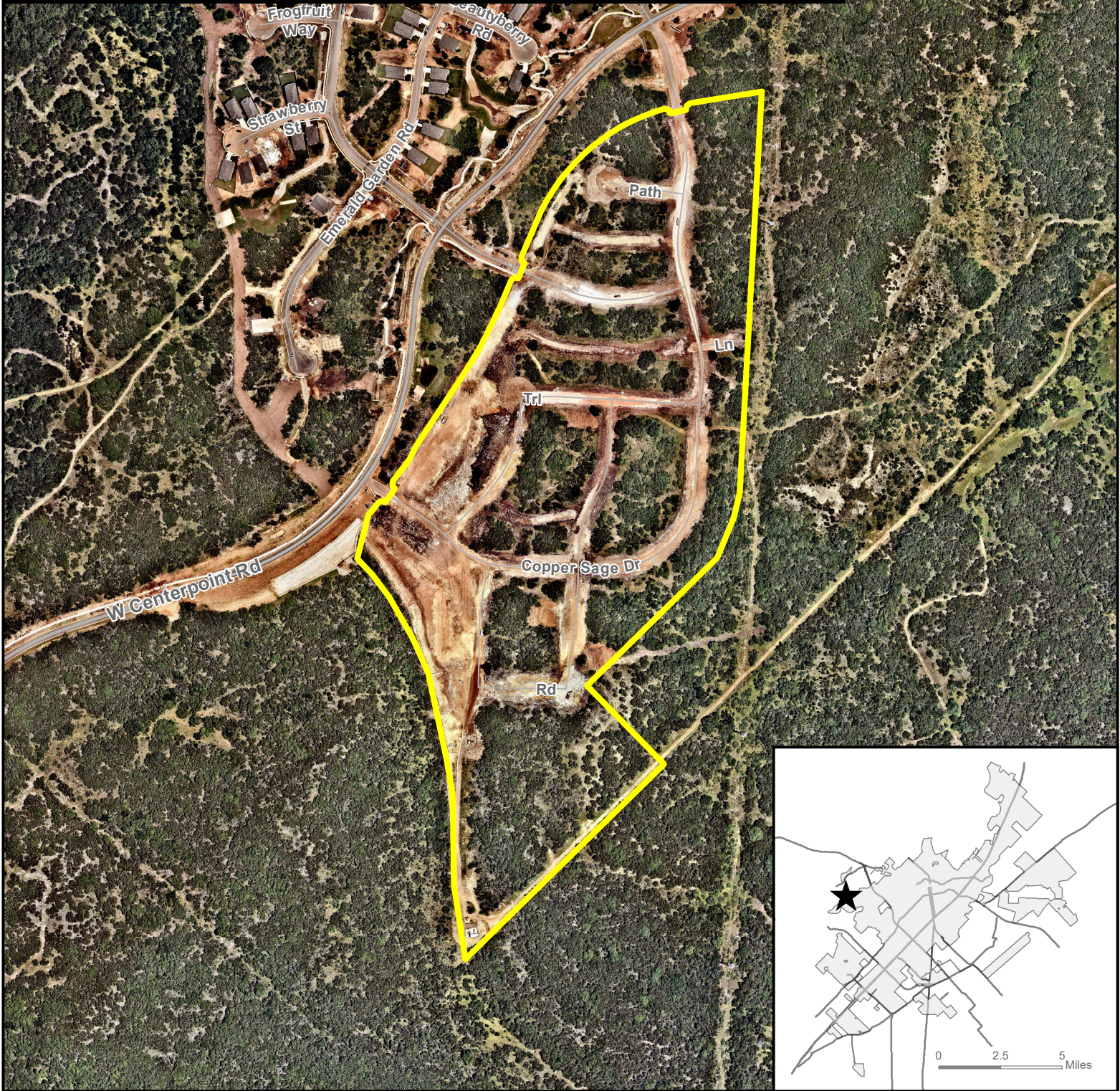

- ★ Site Location
- ▭ Subject Property
- ▭ Parcel
- ▭ City Limit

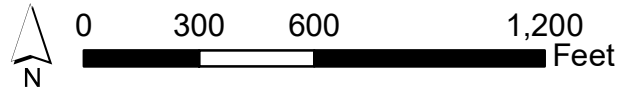

This product is for informational purposes and may not have been prepared for or be suitable for legal, engineering, or surveying purposes. It does not represent an on-the-ground survey and represents only the approximate relative location of property boundaries. Imagery from 2017.

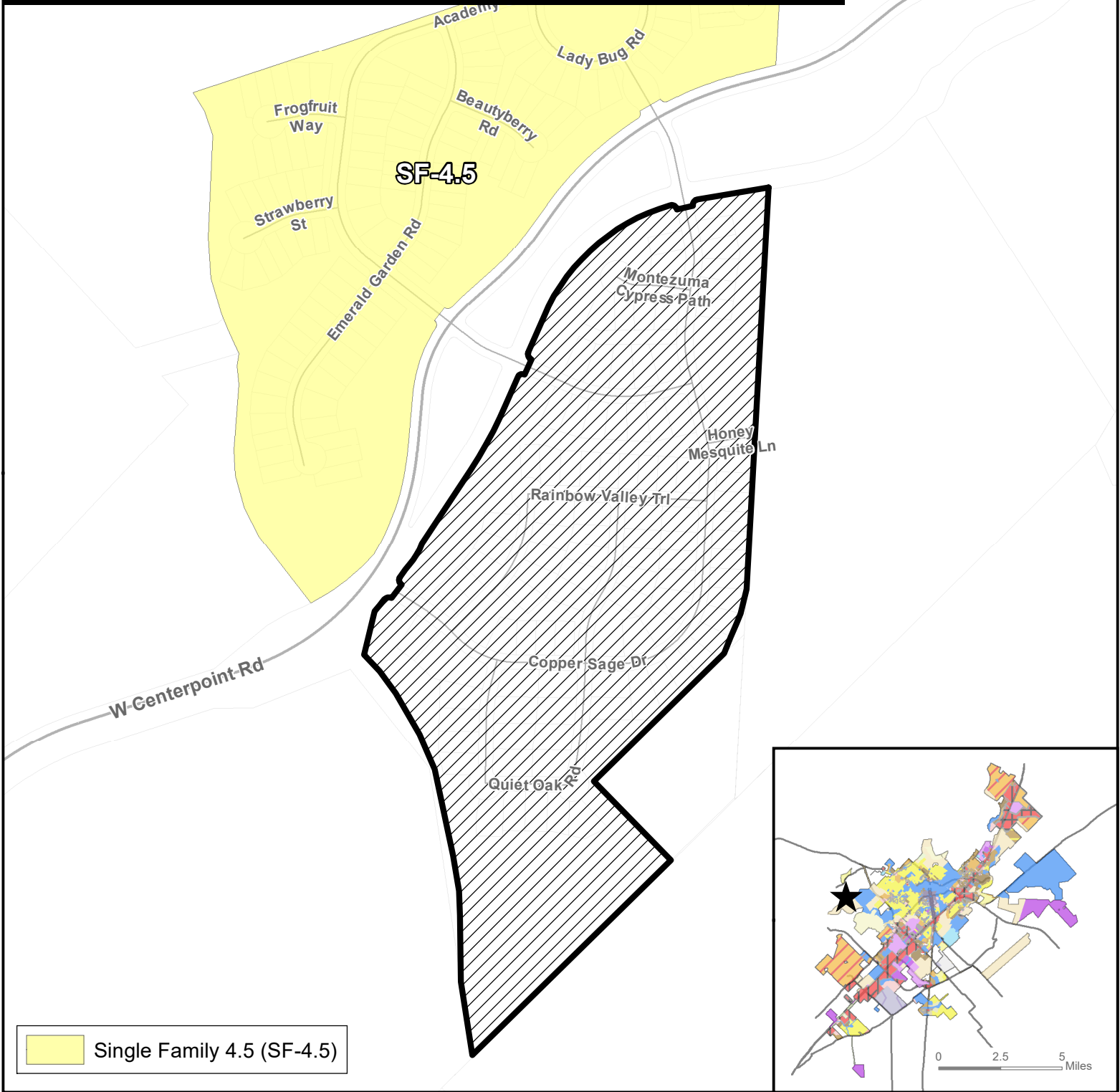

Map Date: 12/31/2019

ZC-20-01 Existing Zoning Map Annexation - La Cima Phase 1, Section 2

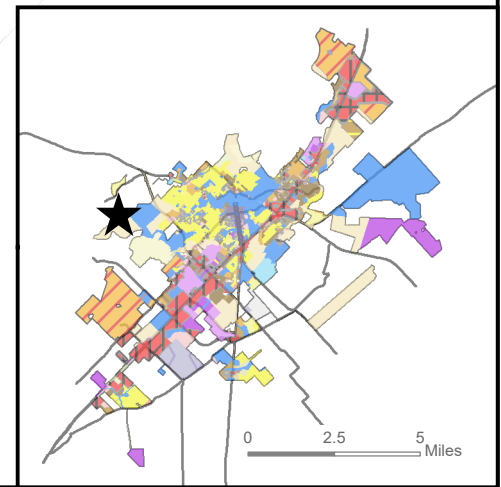

 Single Family 4.5 (SF-4.5)



-  **Site Location**
-  **Subject Property**
-  **Parcel**

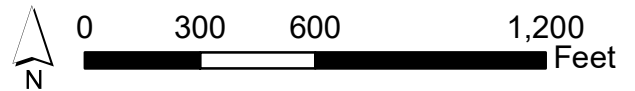





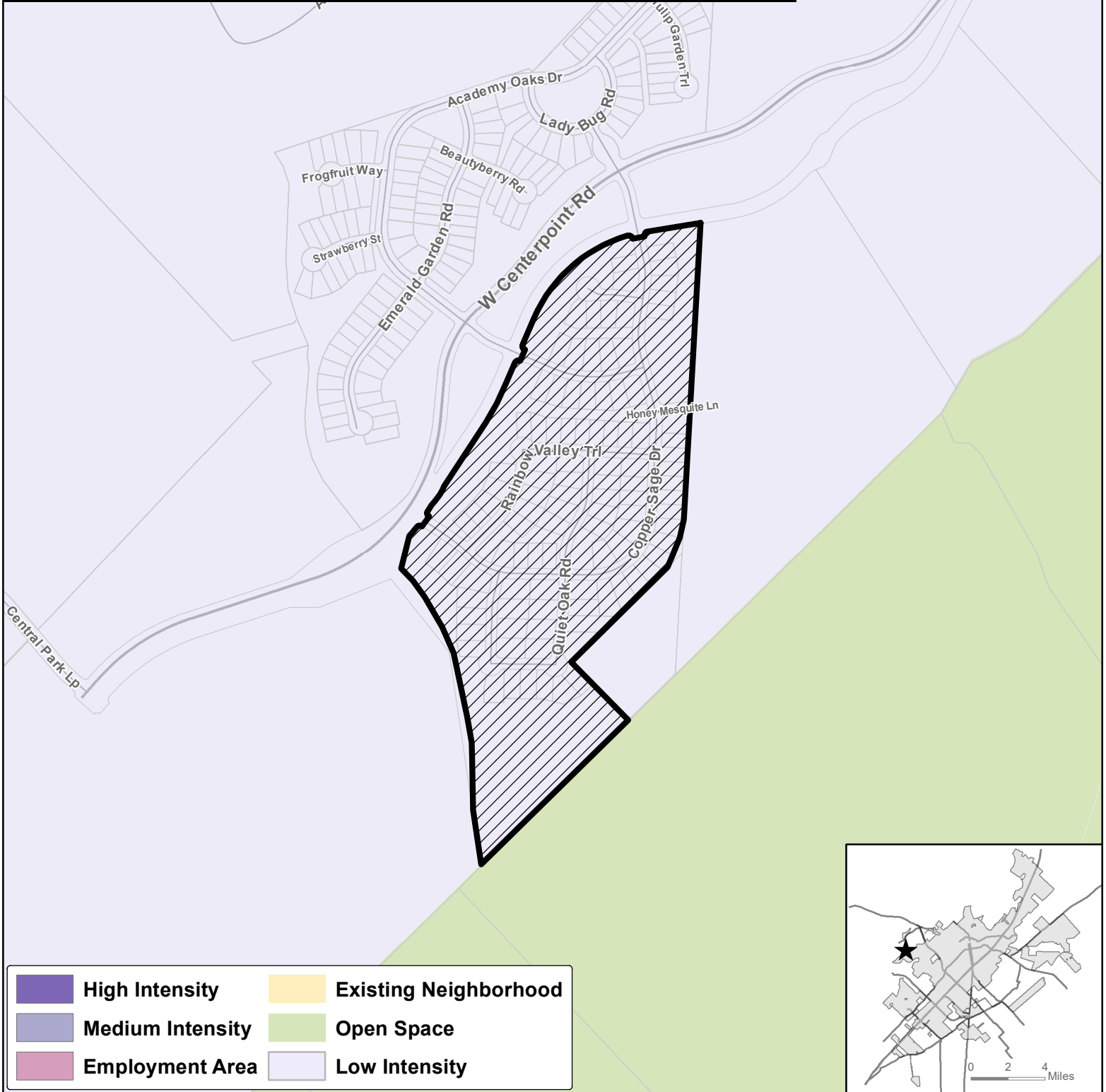

This product is for informational purposes and may not have been prepared for or be suitable for legal, engineering, or surveying purposes. It does not represent an on-the-ground survey and represents only the approximate relative location of property boundaries. Imagery from 2017.





Map Date: 1/15/2020

ZC-20-01 Preferred Scenario FD to SF-4.5 - La Cima Phase 1, Section 2



	High Intensity		Existing Neighborhood
	Medium Intensity		Open Space
	Employment Area		Low Intensity



-  Site Location
-  Subject Property
-  Parcel
-  City Limit

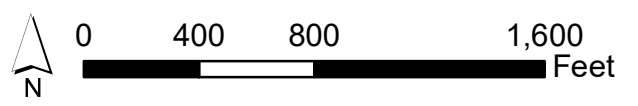





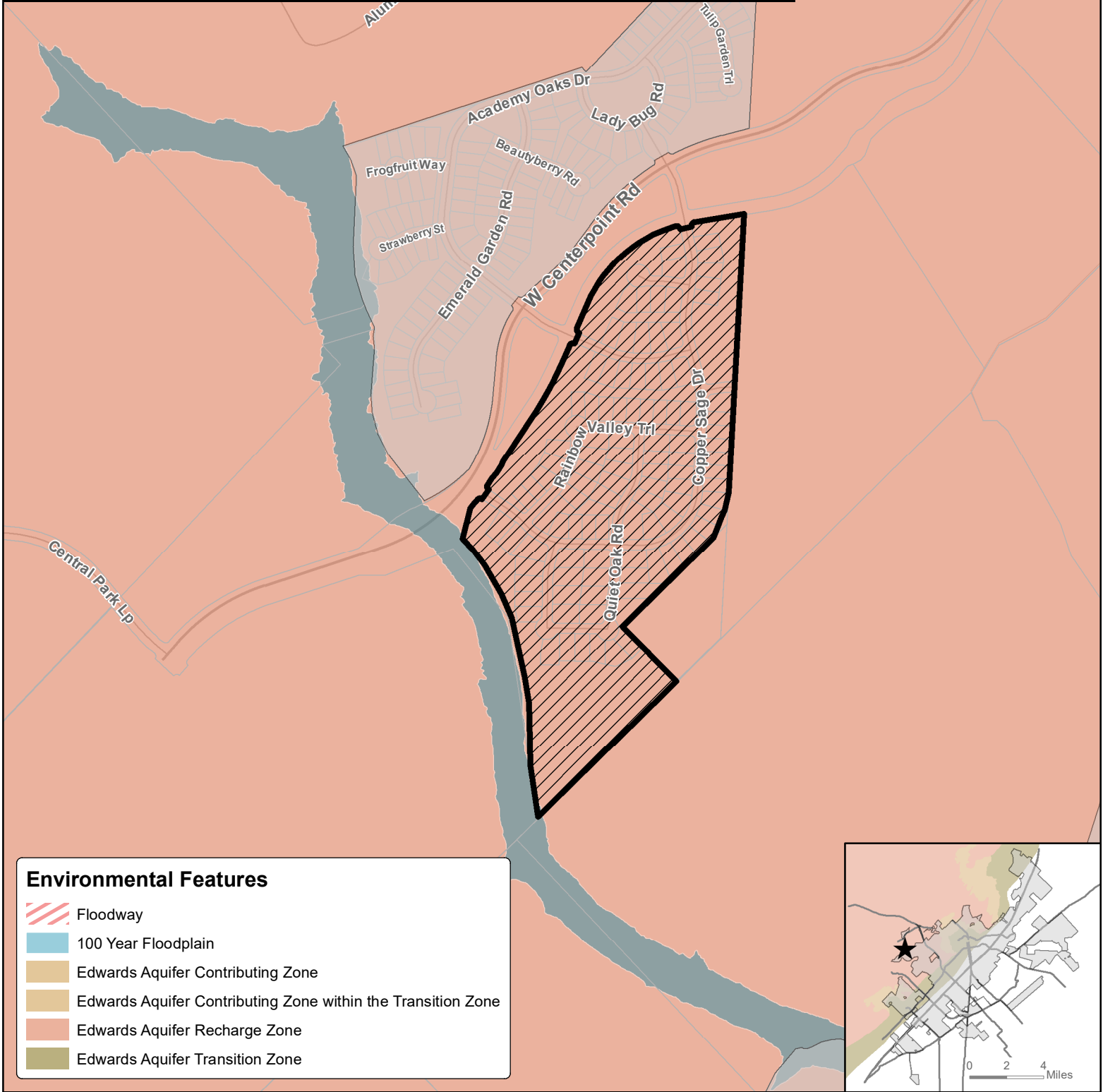

This product is for informational purposes and may not have been prepared for or be suitable for legal, engineering, or surveying purposes. It does not represent an on-the-ground survey and represents only the approximate relative location of property boundaries.





Map Date: 1/7/2020

ZC-20-01 Environmental Features FD to SF-4.5 - La Cima Phase 1, Section 2



Environmental Features

-  Floodway
-  100 Year Floodplain
-  Edwards Aquifer Contributing Zone
-  Edwards Aquifer Contributing Zone within the Transition Zone
-  Edwards Aquifer Recharge Zone
-  Edwards Aquifer Transition Zone

-  **Site Location**
-  **Subject Property**
-  **Parcel**
-  **City Limit**

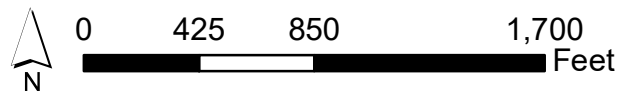



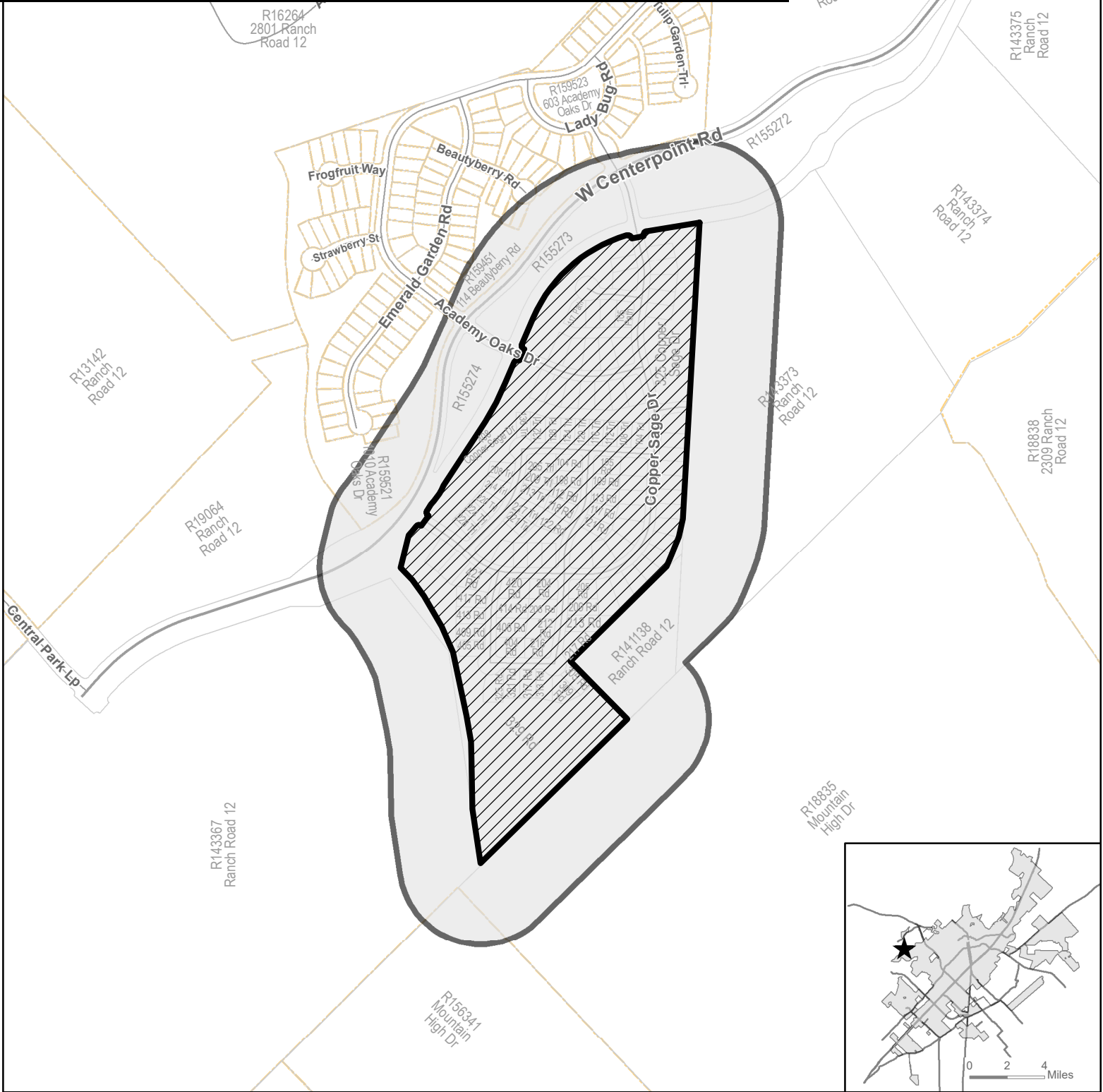

This product is for informational purposes and may not have been prepared for or be suitable for legal, engineering, or surveying purposes. It does not represent an on-the-ground survey and represents only the approximate relative location of property boundaries.

Map Date: 1/6/2020

ZC-20-01 400' Notification Buffer FD to SF-4.5 - La Cima Phase 1, Section 2



- ★ Site Location
-  Subject Property
-  400' Buffer
-  Parcel
-  City Limit

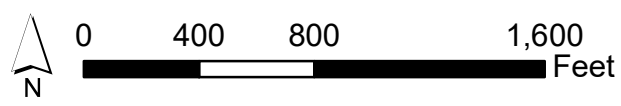

This product is for informational purposes and may not have been prepared for or be suitable for legal, engineering, or surveying purposes. It does not represent an on-the-ground survey and represents only the approximate relative location of property boundaries.

Map Date: 12/20/2019

Property	Site Address	Owner Name	Owner Address	Address 2	Owner City	Owner State	Owner Zip
R159436	132 BEAUTYBERRY RD	HIGHLAND HOMES- AUSTIN, LLC	5601 DEMOCRACY DR	STE 300	PLANO	TX	75024
R159389	123 TULIP GARDEN TRL	LCSM PH 1-1 LLC	303 COLORADO	STE 2300	AUSTIN	TX	78701
R159435	137 BEAUTYBERRY RD	LCSM PH 1-1 LLC	303 COLORADO	STE 2300	AUSTIN	TX	78701
R159437	128 BEAUTYBERRY RD	LCSM PH 1-1 LLC	303 COLORADO	STE 2300	AUSTIN	TX	78701
R159448	169 EMERALD GARDEN RD	LCSM PH 1-1 LLC	303 COLORADO	STE 2300	AUSTIN	TX	78701
R159451	114 BEAUTYBERRY RD	LCSM PH 1-1 LLC	303 COLORADO	STE 2300	AUSTIN	TX	78701
R159509	261 EMERALD GARDEN RD	LCSM PH 1-1 LLC	303 COLORADO	STE 2300	AUSTIN	TX	78701
R159510	257 EMERALD GARDEN RD	LCSM PH 1-1 LLC	303 COLORADO	STE 2300	AUSTIN	TX	78701
R159511	253 EMERALD GARDEN RD	LCSM PH 1-1 LLC	303 COLORADO	STE 2300	AUSTIN	TX	78701
R159521	1010 ACADEMY OAKS DR	LCSM PH 1-1 LLC	303 COLORADO	STE 2300	AUSTIN	TX	78701
R159447	165 EMERALD GARDEN RD	YANEZ JORGE J & DEBRA G	165 EMERALD GARDEN RD		SAN MARCOS	TX	78666
		SARA LEE UNDERWOOD-MYERS	1415 HARPER DR		SAN MARCOS	TX	
		JOSE CANTU	1120 DEBBIE COURT		SAN MARCOS	TX	