

This Exhibit is attached for the purpose of showing, among other things, the general layout of the Shopping Center and approximate location of the Premises. This Exhibit is not final, nor to scale, and is subject to change without notice. Stores referenced are not, and shall in no event be deemed to be representations, covenants or warranties. Nothing herein shall be deemed to create or grant to Tenant any easement or other similar right, nor shall this Exhibit be deemed to limit or restrict Landlord's right to change, alter, contract, or expand all or any part of the Shopping Center, and the site plan is subject to change at Landlord's discretion. Curb cuts are subject to change. Shopping Center boundaries, including for Retail Center Operating Expenses calculations, may change at Landlord's discretion.

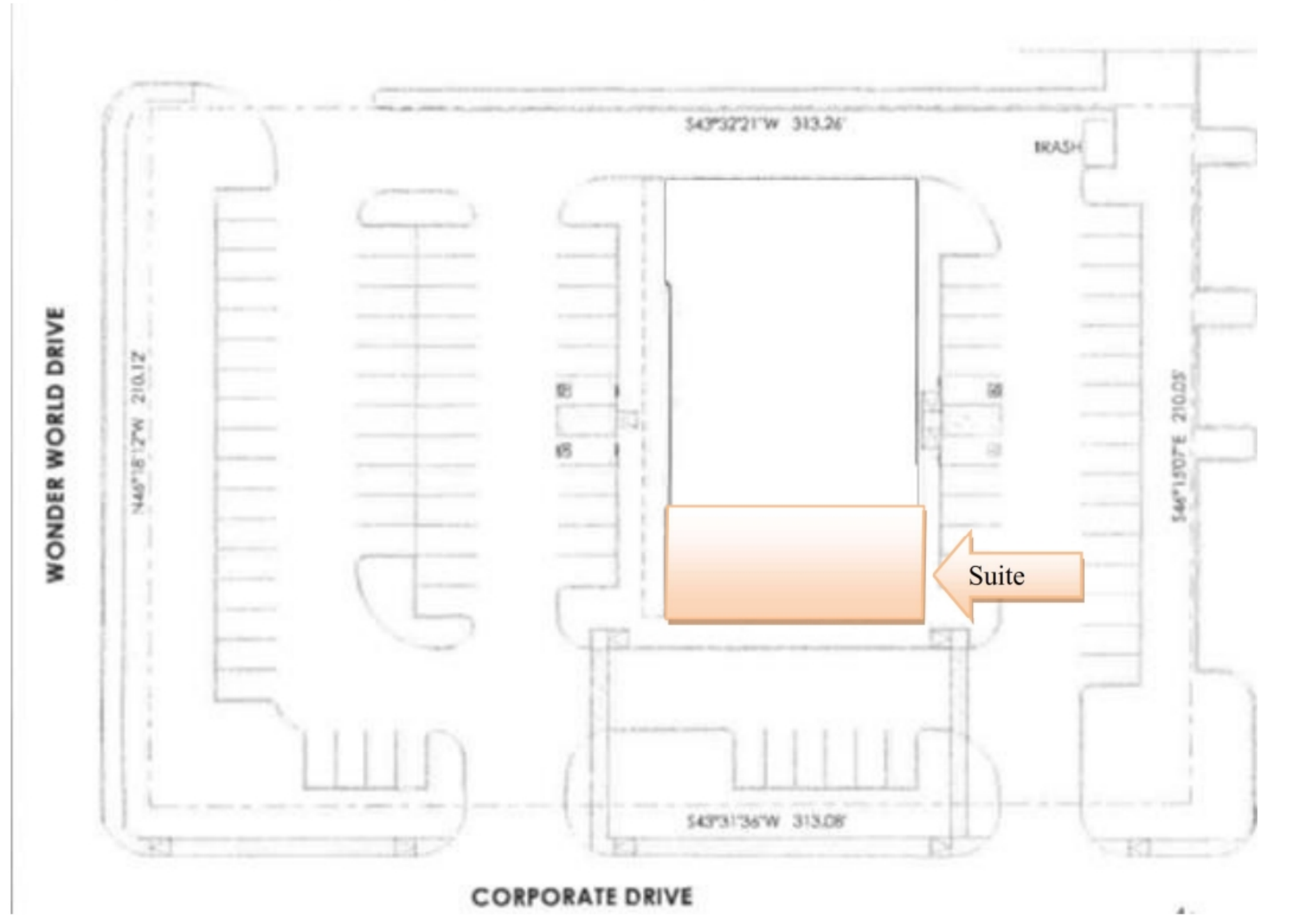



Join TABC in the fight against human trafficking

L-CERT (7/2022)

Submit this form to the proper officials to obtain certification for the type of license/permit for which you are applying as required by TX Alc. Bev. Code, Sections 11.37, 11.39, 11.46(b), 61.37, 61.38, 61.42 and Rule §33.13. This Required Certifications form must be submitted with your Initial Application form.

Contact your local TABC office for assistance.

LOCATION INFORMATION

1. Trade Name of Location (Name of restaurant, bar, store, etc.)
HOKKAIDO RAMEN AND SUSHI BAR

2. Owner of Business/Applicant (Name of Corporation, LLC, etc.)
HOKKAIDO JIN INC

3. Type of Owner
 Corporation Limited Liability Company Partnership
 Limited Partnership Limited Liability Partnership Other: _____

4. Location Address
243 WONDER WORLD DR., STE 100
 City: **SAN MARCOS** County: **HAYS** State: **TX** Zip Code: **78666**

5. Mailing Address
243 WONDER WORLD DR., STE 100
 City: **SAN MARCOS** County: **HAYS** State: **TX** Zip Code: **78666**

6. Business Telephone Number: **5122108099** Alternate Telephone Number: **2147999838** E-mail Address: **JIN12366@YAHOO.COM**

7. Application for:

<input checked="" type="checkbox"/> Original	<input type="checkbox"/> Reinstatement	License/Permit Number	<input type="checkbox"/> Reinstatement and Change of Trade Name	License/Permit Number
	<input type="checkbox"/> Change of Location	License/Permit Number	<input type="checkbox"/> Change of Location and Trade Name	License/Permit Number

8A. Type of Off-Premise Retailer License/Permit:

<input type="checkbox"/> BF Retail Dealer's Off-Premise License	<input type="checkbox"/> E Local Cartage Permit	<input type="checkbox"/> P Package Store Permit
<input type="checkbox"/> BQ Wine and Malt Beverage Retail Dealer's Off-Premise Permit	<input type="checkbox"/> ET Third-Party Local Cartage Permit	<input type="checkbox"/> Q Wine Only Package Store
<input type="checkbox"/> LP Local Distributor's Permit		

8B. Type of On-Premise Retailer License/Permit:

<input type="checkbox"/> BE Retail Dealer's On-Premise License	<input type="checkbox"/> E Local Cartage Permit	<input type="checkbox"/> MB Mixed Beverage
<input checked="" type="checkbox"/> BG Wine and Malt Beverage Retail Dealer's On-Premise Permit	<input checked="" type="checkbox"/> FB Food and Beverage Certificate	<input type="checkbox"/> WP Waterpark Permit
<input type="checkbox"/> BP Brewpub License	<input type="checkbox"/> LH Late Hours Certificate	

8C. Type of Wholesaler's, Distributor's, or Manufacturer's License/Permit:

<input type="checkbox"/> BB General Distributor's License	<input type="checkbox"/> D Distillers and Rectifiers Permit - allows on-premise consumption	<input type="checkbox"/> S Nonresident Seller's Permit
<input type="checkbox"/> BC Branch Distributor's License	<input type="checkbox"/> DS Out-of-State Winery Direct Shipper's Permit	<input type="checkbox"/> SD Brewer's Self-Distribution License
<input type="checkbox"/> BN Nonresident Brewer's License	<input type="checkbox"/> G Winery - allows on-premise consumption	<input type="checkbox"/> W Wholesaler's Permit
<input type="checkbox"/> BW Brewer's License	<input type="checkbox"/> J Bonded Warehouse	<input type="checkbox"/> X General Class B Wholesaler Permit
<input type="checkbox"/> JD Bonded Warehouse (Dry Area)		

9. For On or OFF-Premise Applicants, Indicate Primary Business Type at this Location

<input type="checkbox"/> Bar	<input type="checkbox"/> Grocery/Market	<input type="checkbox"/> Package Store	<input type="checkbox"/> Sexually Oriented
<input type="checkbox"/> Civic Center	<input type="checkbox"/> Hotel	<input type="checkbox"/> Public Entertainment Fac. (PEF as defined in Sec. 108.73)	<input type="checkbox"/> Sporting Arena
<input type="checkbox"/> Convenience Store	<input type="checkbox"/> Motel	<input type="checkbox"/> Racetrack	
<input type="checkbox"/> Delivery Company	<input type="checkbox"/> Movie Theater	<input type="checkbox"/> Restaurant	

Beer & Sake



Kirin Light.....	\$6.00
Kirin Ichiban.....	\$6.00
Asahi.....	\$6.00
Sapporo.....	\$6.00
Goose Island IPA.....	\$6.00

Hot Sake.....	\$9.50
Hana Peach.....	\$17.00
Hana Fuji Apple.....	\$17.00
Hana Lychee.....	\$17.00
Nigori Unfiltered Sake.....	\$16.00
Takara Sierra Cold Sake.....	\$14.50
Ginjo Sake.....	\$17.00
Junmai Daiginjo.....	\$38.00
Junmai Daiginjo Limited Release.....	\$88.00
Winning Horse.....	\$128.00





Orange Theory

KOLACHE BAKERY
& COFFEE SHOP

T-Mobile

LUSH
NAILS & SPA

北海道

HOKKAIDO
Ramen and Sushi



Hokkaido

Ramen House

Tel: 432-606-0011

243 Wonder World Dr # 100

San Marcos TX 78666

Equipment

16' Display

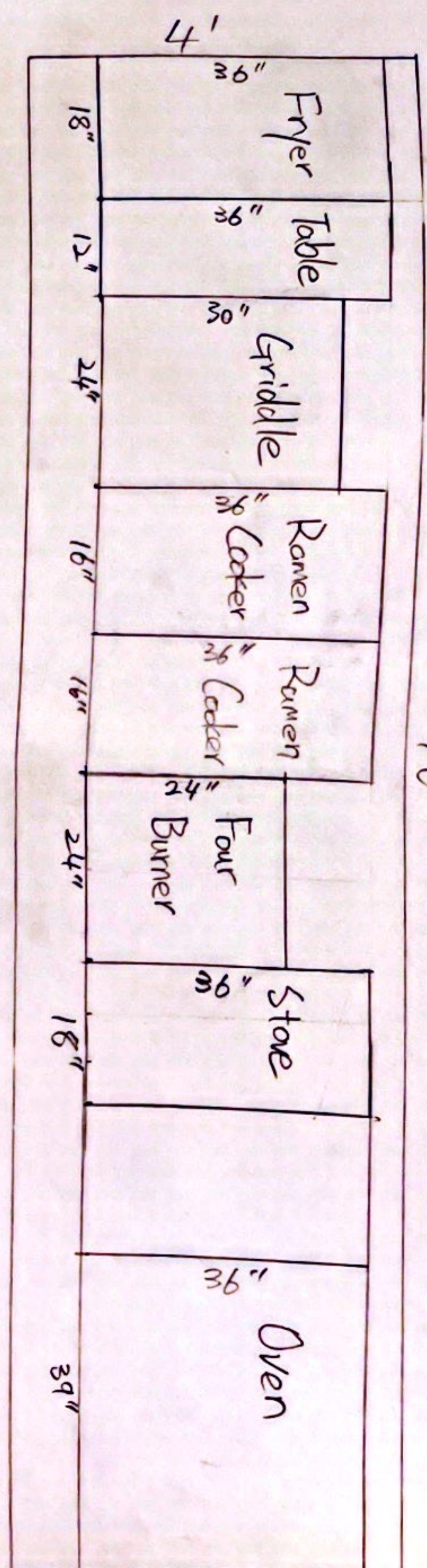

Kitchen ceiling — waterproof, washable and fire-rated High-Grade PVC
 Kitchen walls — solid vinyl washable sheets
 Dine-in walls — wall panel with dark brown paint
 Floors — concrete floor
 Grease trap — Back Exit of the building
 Back Flow — by the Ice Machine.
 Inlined connections — Under Ice Machine
 three compartment sink and single compartment sink

