



PC-20-14 (Trace PID Phase 3)

Consider a request by Caren Williams-Murch, on behalf of Highpoint Trace, LLC, to approve a Final Plat, consisting of approximately 6.048 acres, more or less, out of the William H. Van Horn Survey generally located at the intersection of Van Horn Trace and Esplanade Parkway.
(A.Villalobos)



Location:

- Proposing public right-of-way and 5 landscape lots
- Located in the Trace Planned Development District (PDD)
- Low Intensity designation on the Comprehensive Plan
- Surrounding uses include single-family, vacant land, and parkland

PC-20-14 Aerial View TracePID Phase 3 - Intersection of Esplanade Parkway and Van Horn Trace

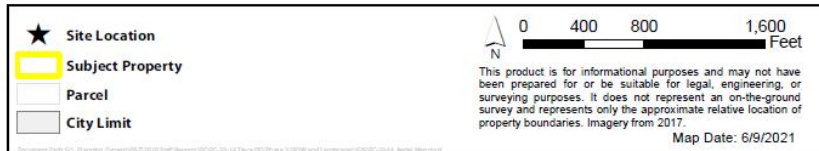



Recommendation

Staff recommends approval of the request as presented.